**NEWINGTON ROAD ZEBRA CROSSING SCHEME – Member Highway Fund Scheme
RESULTS OF CONSULTATION**

To: **Thanet Joint Transportation Board, 15th March 2012**

Main Portfolio Area: **KCC – Enterprise and Environment**

By: **Director of Highways, Kent County Council**

Classification: **Unrestricted**

Ward: **Northwood** Division: **Ramsgate**

Summary: The report summarises the results of the public consultation for a new pedestrian crossing and associated zigzag lines in Newington Road, Ramsgate.

For Information

1.0 Introduction and Background

- 1.1 Kent County Council (KCC), is proposing the introduction of a new zebra crossing in Newington Road, Ramsgate
- 1.2 Residents and pupils from the nearby schools have requested a new crossing facility to assist pedestrians when crossing the Newington Road, in particular for children and parents when crossing to reach the Dame Janet Community Infant and Junior Schools.
- 1.3 The principle scheme aim is to improve pedestrian safety when crossing Newington Road. The scheme also aims to lower vehicle speeds in the area which has been raised as a concern by residents.
- 1.4 A crash analysis was carried out in Newington Road from its junction with Margate Road to its junction with Allenby Road / Stirling Way (a distance of 440 metres) to ascertain if a crash record is present. In the last three years six slight injury crashes were reported, three of these involved pedestrians but no crash pattern was identified.
- 1.5 To safely install a new pedestrian crossing in the vicinity of the schools in Newington Road some on street parking will need to be removed. The proposed site has been deemed the most suitable location for a crossing, but will require the removal of all on street parking spaces between nos. 177 and 185 Newington Road.

2.0 Summary of consultation response

- 2.1 A scheme proposal was prepared and put forward for public consultation. The scheme proposal may be seen in Annex 1.
- 2.2 The consultation period ran for just over 3 weeks, from 10th February to 5th March 2012. Information leaflets and feedback forms were distributed to 50 immediately affected residents and businesses and 5 notification posters were placed along Newington Road and Roman Road.

- 2.3 Responses to this consultation will be updated as soon as the consultation period ends on the 5th March and a copy of these will be available at the JTB meeting. If no objections are received then the scheme will be progressed as outlined.
- 2.4 All of the consultation information was made available on the www.kent.gov.uk website, which included the opportunity to comment via an email feedback form. Other consultees directly contacted included Thanet District Council, the local District and County Councillors, the emergency services and bus companies.
- 2.5 Consultees were asked whether they supported the proposals, and were also given the opportunity to make additional comments. A summary of the responses received at the time this report went to print can be seen below and in Annex 2. A full summary of responses will be available at the JTB meeting once the consultation period ends on the 5th of March.

2.6

Do you support the proposed zebra crossing in Newington Road?	
Yes	No
88.9% (8)	11.1% (1)

- 2.7 The Head teacher of the Dame Janet Community Junior School has provided strong support for the scheme as has the local district councillors.
- 2.8 A copy of the consultation responses can be viewed upon request.

3.0 Financial

- 3.1 The scheme will cost £18,882 to implement. This will include hi-friction road surfacing on approach to the crossing. Kent County Councillor Elizabeth Green has chosen to use some of her Member Highway Fund allocation to progress and construct this scheme.

4.0 Recommendation

- 4.1 Funding is to be fully delivered by Elizabeth Green and based on the results of the public consultation it is proposed that the scheme proceed as outlined.

Contact Officer:	<i>Ryan Shiel, Traffic Engineer 08458 247800</i>
Reporting to:	<i>Andy Corcoran, Traffic Schemes and Member Highway Fund Manager</i>

Annex List

<i>Annex 1</i>	<i>Scheme Proposal / Plan</i>
<i>Annex 2</i>	<i>Consultation Responses</i>

NEWINGTON ROAD ZEBRA CROSSING SCHEME – Member Highway Fund Scheme

Annex 1 – Scheme Proposal / Plan

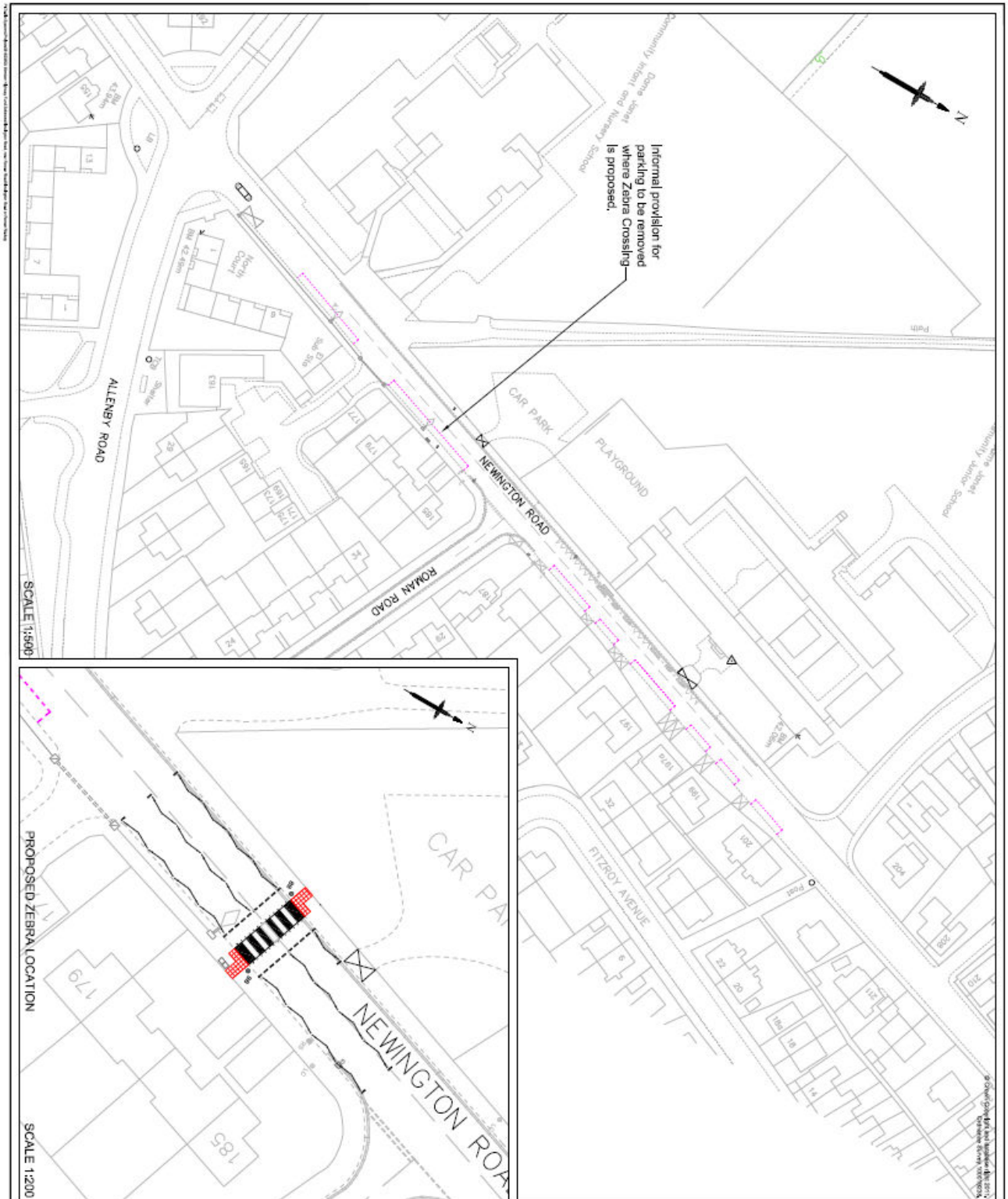

<p>CSM/16900062</p>	<p>Access Driveway</p> <p>Private Car</p> <p>Existing Lane Columns</p> <p>Existing Road Signs</p> <p>Existing Street Signs</p> <p>Ballistic Screens</p> <p>Traffic Parking</p>	<p>North Devon Council</p> <p>Highway Department</p> <p>Member Highway Fund Scheme</p> <p>Proposed Zebra Crossing</p> <p>North Devon Council</p> <p>Highway Department</p> <p>Member Highway Fund Scheme</p> <p>Proposed Zebra Crossing</p>	<p>North Devon Council</p> <p>Highway Department</p> <p>Member Highway Fund Scheme</p> <p>Proposed Zebra Crossing</p> <p>North Devon Council</p> <p>Highway Department</p> <p>Member Highway Fund Scheme</p> <p>Proposed Zebra Crossing</p>	<p>North Devon Council</p> <p>Highway Department</p> <p>Member Highway Fund Scheme</p> <p>Proposed Zebra Crossing</p> <p>North Devon Council</p> <p>Highway Department</p> <p>Member Highway Fund Scheme</p> <p>Proposed Zebra Crossing</p>	<p>North Devon Council</p> <p>Highway Department</p> <p>Member Highway Fund Scheme</p> <p>Proposed Zebra Crossing</p> <p>North Devon Council</p> <p>Highway Department</p> <p>Member Highway Fund Scheme</p> <p>Proposed Zebra Crossing</p>
----------------------------	---	---	---	---	---

NEWINGTON ROAD ZEBRA CROSSING SCHEME – Member Highway Fund Scheme
Annex 2 – Consultation Responses

Item	Comment received	KCC response
1.	Supports the need for a pedestrian crossing but, this scheme removes on street parking which is needed in front of my property. Would it be possible to remove some of the double yellow lines in the Newington Road Cul-de-sac (serving nos. 163-175) to provide some extra parking?	The double yellow line parking restrictions have been installed in this road to ensure access and visibility can be maintained. Additionally this is a private parking area which is not publically owned or maintained.
2.	The scheme is a welcome and long over due safety measure. With 2 primary schools and over 600 children coming out onto Newington Road it makes perfect sense to locate the zebra crossing according to the proposal.	Comment noted.
3.	More speed limits signs and parking enforcement is also needed along this section of Newington Road.	The highway code states that in the absence of any signage to say otherwise, any road which is served by a system of street lighting is a 30mph restricted speed road. It is prohibited by the Department for Transport (DfT) to install 30mph repeater signs on street lit 30mph roads. Enforcement of parking restrictions is a Thanet District Council (TDC) responsibility
4.	Believes a crossing should have been installed a long time ago.	Comment noted.
5.	Can something be done about the parking in Newington Road? At school times you cannot move because parents park inconsiderately. Double yellow lines are present but, not enough enforcement takes place.	TDC to action.
6.	Will the school still have a crossing patrol i.e. lolly pop lady?	The scheme does not require or include the removal of the existing school crossing patrol. KCC Highways do not employ the crossing patrol staff they are managed by the schools themselves.